

## Door Closer & Stainless Steel Cover

### Product information

Strong spring to guarantee powerful closing, with side rocker for easy installation. An aluminium alloy body and two coatings for protection. Two speed controls - closing speed and latching speed.



D205



D205B

Product code	Description	Weight (kg)	Door width (mm)	Packaging unit
D205	Door closer - V arm	30 - 65	500 - 1200	1
D205B	Door closer - slide arm	30 - 65	500 - 1200	1

## Door Closer & Aluminium Cover

### Product information

Strong spring to guarantee powerful closing, with side rocker for easy installation. An aluminium alloy body and two coatings for protection. Two speed controls - closing speed and latching speed.



D206

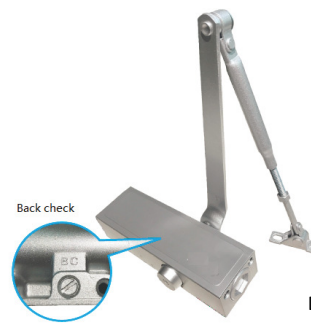

D206B

Product code	Description	Weight (kg)	Door width (mm)	Packaging unit
D206	Door closer - V arm	up to 120	500 - 1200	1
D206B	Door closer - slide arm	up to 85	500 - 1200	1

## Concealed Door Closer

### Product information

Strong spring to guarantee powerful closing, with side rocker for easy installation. An aluminium alloy body and two coatings for protection. Two speed controls - closing speed and latching speed.



D401-R



D401-S

Product code	Description	Weight (kg)	Door width (mm)	Packaging unit
D401-R	Door closer - concealed	35 - 60	500 - 1200	1
D401-S	Door closer - concealed	35 - 60	500 - 1200	1